



OMEC NORTH AMERICA INC

CAST IRON - GENERAL PURPOSE MOTORS

PRODUCT FEATURES

Model Number	OMT3-180M00-4 18.5KW		
Standard	IEC 60034-1	Output	18.50 KW
Hazardous Classification	None (Safe Area)	No of Poles	4 Pole
Efficiency Class	IE3	Frame Size	180M
Number of Phases	3 Phase- Induction	Mounting Type	B3; B35, B5, V1
Material of Construction	Cast Iron	Enclosure Type / Cooling	TEFC-IC411
Insulation Class	Class F	Degree of Protection	IP55
Temperature Rise Class	80K (B class)	Duty Cycle	S1- Continuous Duty
Ambient Temperature	-15°C ~ 50°C	Service Factor	SF 1.15
Starting Method	DOL / WYE-DELTA	Operating Altitude	1000 masl

TECHNICAL DETAILS

Winding Connection	Δ (Delta)						
Frequency	50Hz			60Hz			
Rated Speed	1470 Rpm			1760 Rpm			
Voltage	380	400	415	380	400	440	460
Full Load Current [IN]	35.30 A	33.53 A	32.32 A	35.30 A	33.53 A	30.48 A	29.16 A
Locked Rotor Current [IL / IN]	7.8	7.8	7.8	7.8	7.8	7.8	7.8
Full Load Torque [TN]	120.19 Nm	120.19 Nm	120.19 Nm	100.38 Nm	100.38 Nm	100.38 Nm	100.38 Nm
Locked Rotor Torque [TL / TN]	2.0	2.0	2.0	2.4	2.4	2.4	2.4
Breakdown Torque [TB / TN]	2.3	2.3	2.3	2.8	2.8	2.8	2.8
Efficiency	50% load	91.2%	91.2%	91.2%	91.2%	91.2%	91.2%
	75% load	92.5%	92.5%	92.5%	92.5%	92.5%	92.5%
	100% load	92.6%	92.6%	92.6%	92.6%	92.6%	92.6%
Power Factor (cos φ)	50% load	0.69	0.69	0.69	0.69	0.69	0.69
	75% load	0.80	0.80	0.80	0.80	0.80	0.80
	100% load	0.86	0.86	0.86	0.86	0.86	0.86

OTHER DETAILS

Bearing Configuration (DE / NDE)	Ball Bearing / Ball Bearing		
Bearing Lubrication Type	Grease - ESSO UNIREX N2		
Bearing Series Type	DE:	6311/C3	NDE: 6311/C3
Vibration	2.2 mm/sec	Direction of Rotation	CW or CCW
Moment of inertia (kg.m ²)	0.1932	Sound Pressure Level	80 dB(A)
Final Colour	RAL-5012 : BLUE	Paint Specification	2 Pack Epoxy
Terminal Box Position	TOP/SIDE	Weight	190 kg

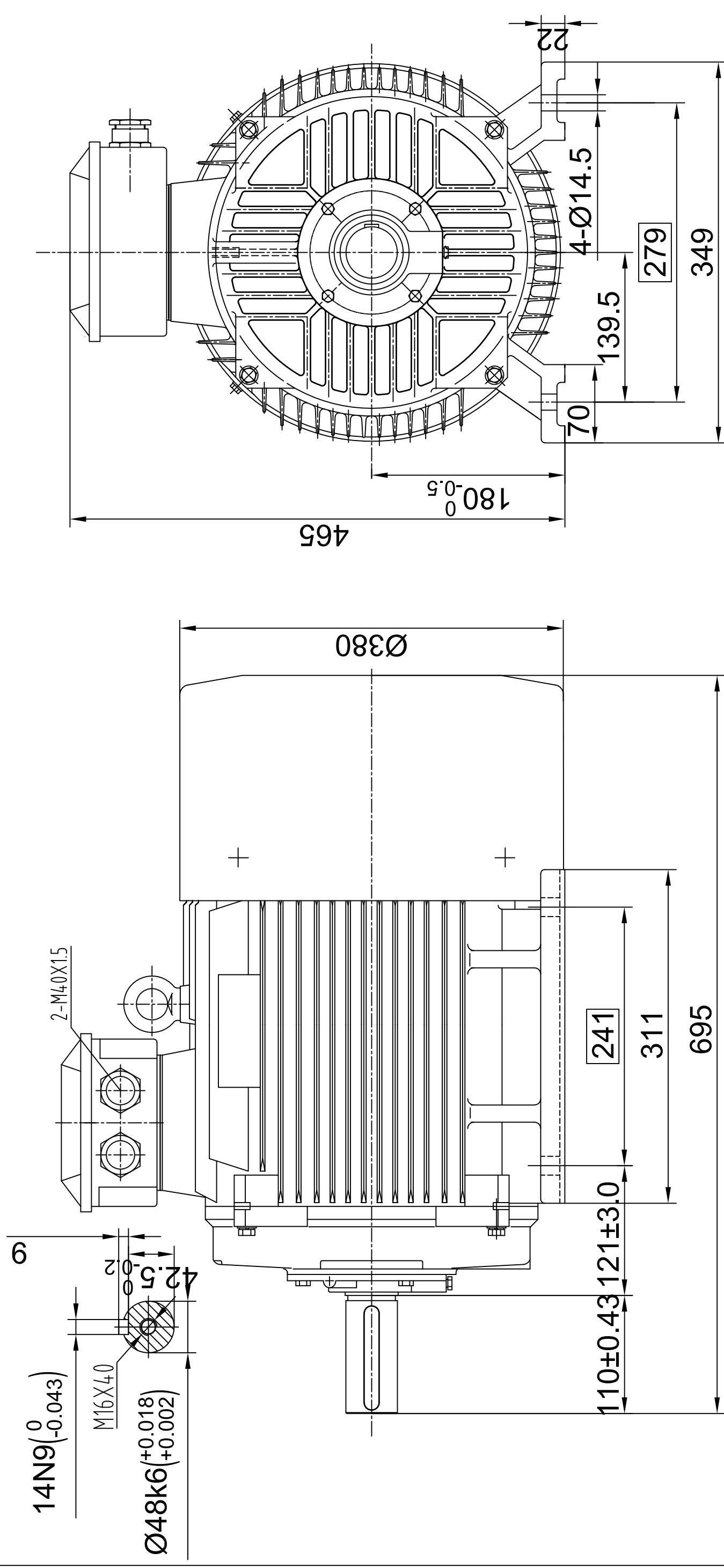

Description: OMT3 Type-1

Motor Frame: 180M



Drawing Title:

Outline Drawing

Sheet No.	Dim. mm	Size	Scale
1 OF 1	mm	A3	1:5

IP55-Cast Iron B3 MOTORS

OMEC NORTH AMERICA INC.

Drawn By	Date	Approved By	Rev.
A.J.B.	15.Jan.2025	-----	00



OMEC NORTH AMERICA INC.

Performance Curves

kW: 18.5 RPM: 1470

IE3 GENERAL PURPOSE MOTORS- OMT 400V 50Hz

