



# OMEC NORTH AMERICA INC

CAST IRON - GENERAL PURPOSE MOTORS

## PRODUCT FEATURES

Model Number	OMT3-100L00-2 3KW		
Standard	IEC 60034-1	Output	3.00 KW
Hazardous Classification	None (Safe Area)	No of Poles	2 Pole
Efficiency Class	IE3	Frame Size	100L
Number of Phases	3 Phase- Induction	Mounting Type	B3; B35, B14, B5, V1
Material of Construction	Cast Iron	Enclosure Type / Cooling	TEFC-IC411
Insulation Class	Class F	Degree of Protection	IP55
Temperature Rise Class	80K (B class)	Duty Cycle	S1- Continuous Duty
Ambient Temperature	-15°C ~ 50°C	Service Factor	SF 1.15
Starting Method	DOL / WYE-DELTA	Operating Altitude	1000 masl

## TECHNICAL DETAILS

Winding Connection	Y (Star)						
Frequency	50Hz			60Hz			
Rated Speed	2880 Rpm			3455 Rpm			
Voltage	380	400	415	380	400	440	460
Full Load Current [ IN ]	6.02 A	5.71 A	5.51 A	6.02 A	5.71 A	5.19 A	4.97 A
Locked Rotor Current [ IL / IN ]	7.3	7.3	7.3	7.3	7.3	7.3	7.3
Full Load Torque [ TN ]	9.95 Nm	9.95 Nm	9.95 Nm	8.29 Nm	8.29 Nm	8.29 Nm	8.29 Nm
Locked Rotor Torque [ TL / TN ]	2.2	2.2	2.2	2.6	2.6	2.6	2.6
Breakdown Torque [ TB / TN ]	2.3	2.3	2.3	2.8	2.8	2.8	2.8
Efficiency	50% load	84.9%	84.9%	84.9%	84.9%	84.9%	84.9%
	75% load	87.0%	87.0%	87.0%	87.0%	87.0%	87.0%
	100% load	87.1%	87.1%	87.1%	87.1%	87.1%	87.1%
Power Factor (cos φ)	50% load	0.76	0.76	0.76	0.76	0.76	0.76
	75% load	0.83	0.83	0.83	0.83	0.83	0.83
	100% load	0.87	0.87	0.87	0.87	0.87	0.87

## OTHER DETAILS

Bearing Configuration (DE / NDE)	Ball Bearing / Ball Bearing		
Bearing Lubrication Type	Grease - Mobil Polyrex EM		
Bearing Series Type	DE:	6206-2Z/C3	NDE: 6206-2Z/C3
Vibration	1.6 mm/sec	Direction of Rotation	CW or CCW
Moment of inertia (kg.m <sup>2</sup> )	0.0051	Sound Pressure Level	82 dB(A)
Final Colour	RAL-5012 : BLUE	Paint Specification	2 Pack Epoxy
Terminal Box Position	TOP/SIDE	Weight	35 kg

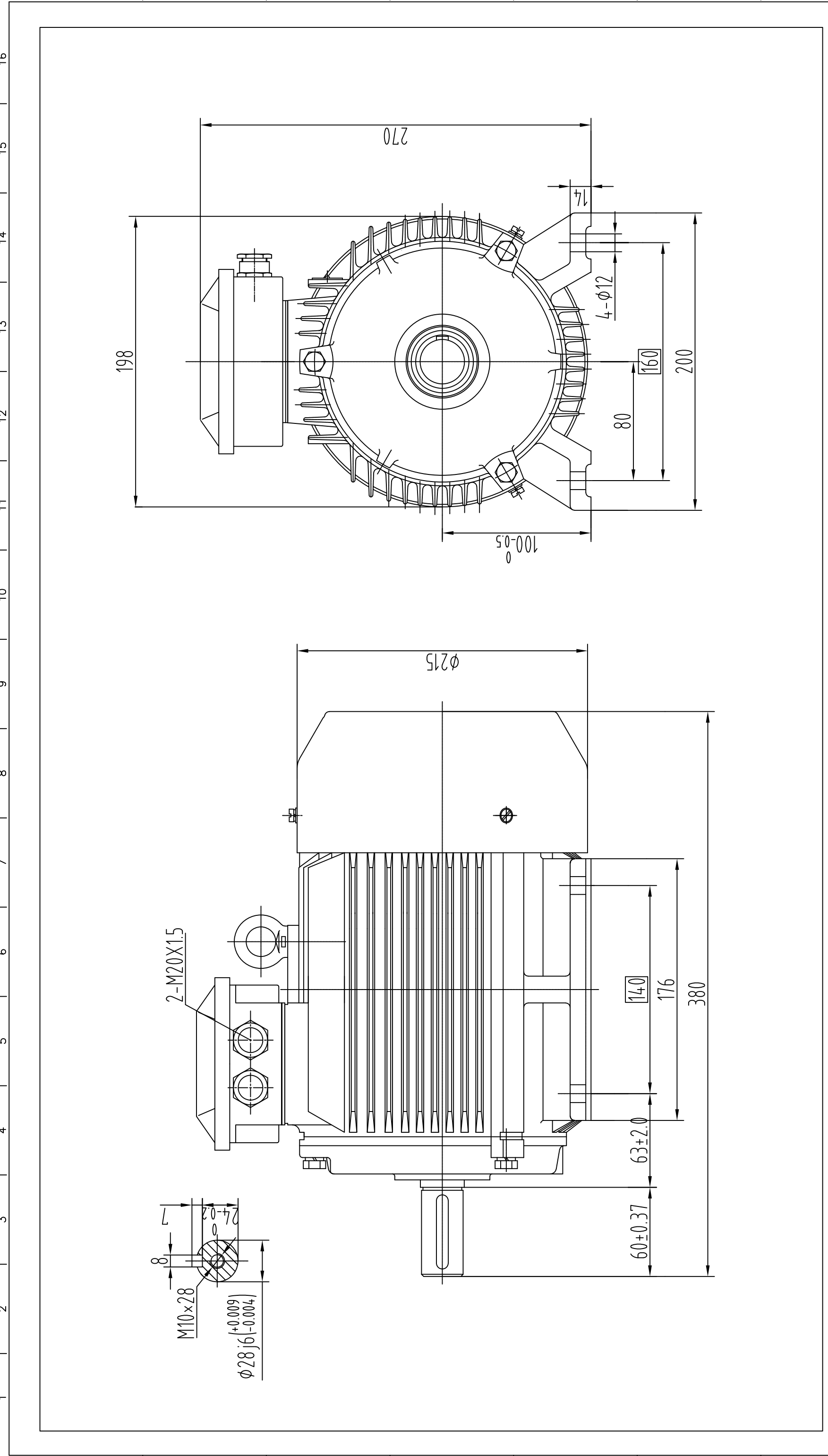

# IP55-Cast Iron B3 MOTORS

OMEC NORTH AMERICA INC.

Description: OMT3 Type-1

Motor Frame: 100L



Drawing Title:

Outline Drawing

Sheet No.	Dim. mm	Size	Scale
1 OF 1	mm	A3	1:5

A.J.B. 15.Jan.2025 00

Drawn By Date Approved By Rev.



# OMEC NORTH AMERICA INC.

## Performance Curves

kW: 3 RPM: 2880

IE3 GENERAL PURPOSE MOTORS- OMT 400V 50Hz

